

AC,AD

系列 油壓緩衝器



series OIL PRESSURE BUFFER

AC 無調整鈕 No Adjust Switch

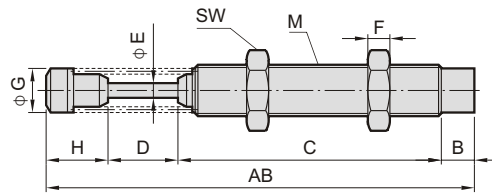

帶有塑膠頭彈簧
Have head and spring

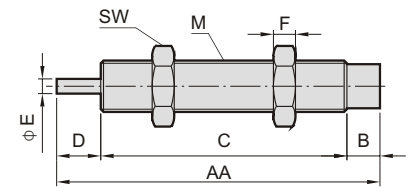

沒帶塑膠頭 No head

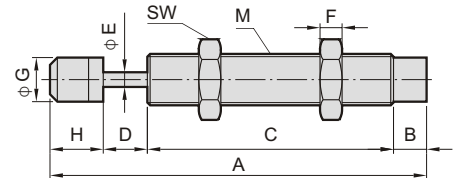

帶有塑膠頭 Have head

訂購標示 How to order	A	AA	AB	B	C	D	E	F	G	H	M	SW	最大吸收 Max. Nm	行程 Stroke	重量 (g)
AC-0806-2	52.4	44	—	5	33	6	2.8	3	6.6	8.4	M8×P1.0	11	2	6	11
AC-1005-2	41.2	32.7	—	4.8	22.9	5	3	3	8.6	8.5	M10×P1.0	12.7	3	5	14
AC-1008-2	59.5	51	—	5	38	8	3	3	8.6	8.5	M10×P1.0	12.7	4	8	20
AC-1210-2	69.5	60	—	4.5	45.5	10	3	4	10.3	9.5	M12×P1.0	14	2	10	31.5
AC-1412-2	102.5	88	—	9	67	12	4	6	12	14.5	M14×P1.5	19	15	12	80
AC-1416-2	125.5	111	—	9	86	16	4	6	12	14.5	M14×P1.5	19	20	16	90
AC-2020-2	146.5	130	—	9	101	20	6	8	18	16.5	M20×P1.5	26	40	20	215
AC-2050-2	233.5	—	—	9	158	50	6	8	18	16.5	M20×P1.5	26	60	50	300
AC-2525-2	154.3	—	—	10	101	25	8	10	22	18.3	M25×P1.5	32	80	25	330
AC-2540-2	—	—	208.3	10	127	40	8	10	22	31.3	M25×P1.5	32	120	40	430
AC-3660-2	—	—	243	11	151	60	10	15	35	21	M36×P1.5	46	250	60	1030

AD 調整鈕 Adjust Switch

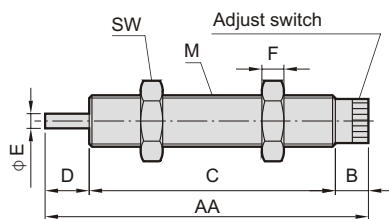

沒帶塑膠頭 No head

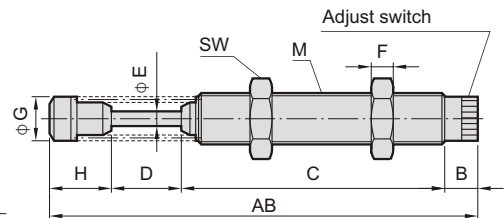

帶有塑膠頭彈簧
Have head and spring

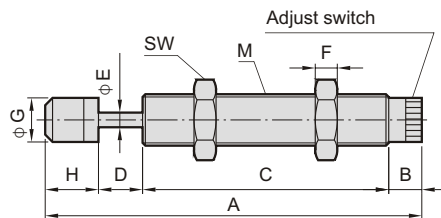

帶有塑膠頭 Have head

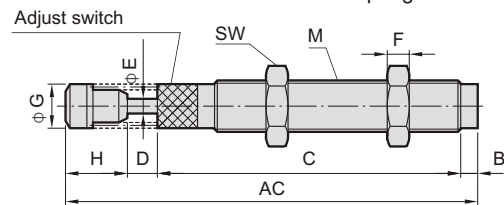

帶有塑膠頭彈簧
Have head and spring

訂購標示 How to order	A	AA	AB	AC	B	C	D	E	F	G	H	M	SW	最大吸收 Max. Nm	行程 Stroke	重量 (g)
AD-1410	113.5	99	—	—	16	73	10	4	6	12	14.5	M14×P1.5	19	20	10	90
AD-2016	149.5	133	—	—	16	101	16	6	8	18	16.5	M20×P1.5	26	25	16	230
AD-2525	161.8	—	—	—	17.5	101	25	8	10	22	18.5	M25×P1.5	32	85	25	350
AD-2540	—	—	215.8	—	17.5	127	40	8	10	22	31.3	M25×P1.5	32	100	40	455
AD-3650	—	—	242	—	8	163	50	10	15	35	21	M36×P1.5	46	300	50	1100
AD-4225	—	—	—	186.5	5	130.5	17	12	15	44.5	34	M42謨P1.5	50	260	17	1280
AD-4250	—	—	—	240.9	5	160	42	12	15	44.5	34	M42謨P1.5	50	500	42	1490
AD-4275	—	—	—	301.5	5	190.5	67	12	15	44.5	39	M42謨P1.5	50	750	67	1710